



QCELLS Wi-Fi Commission Instruction

Page 1 of 3



STEP 1

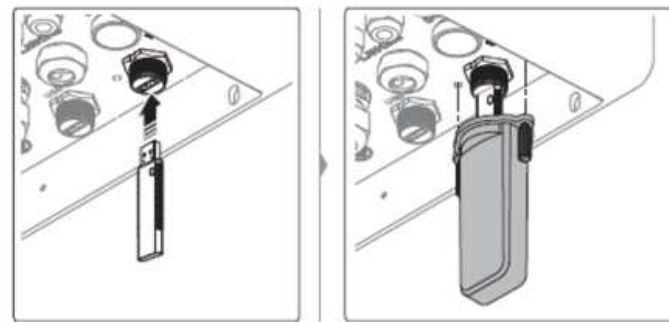

The Wi-Fi dongle is located on the right-side underneath the inverter with a grey cover.

STEP 2

Stay near the inverter and check whether there is a WIFI signal called "DIRECT-QHomeAP" on your mobile WIFI list.

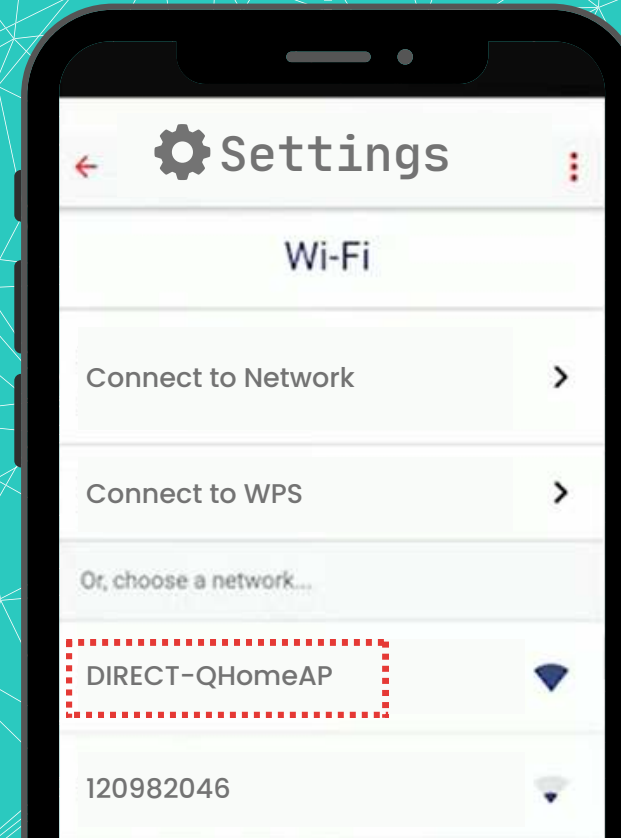

STEP 3

Connect to Wi-Fi "DIRECT-QHomeAP" the password is **qhome123**

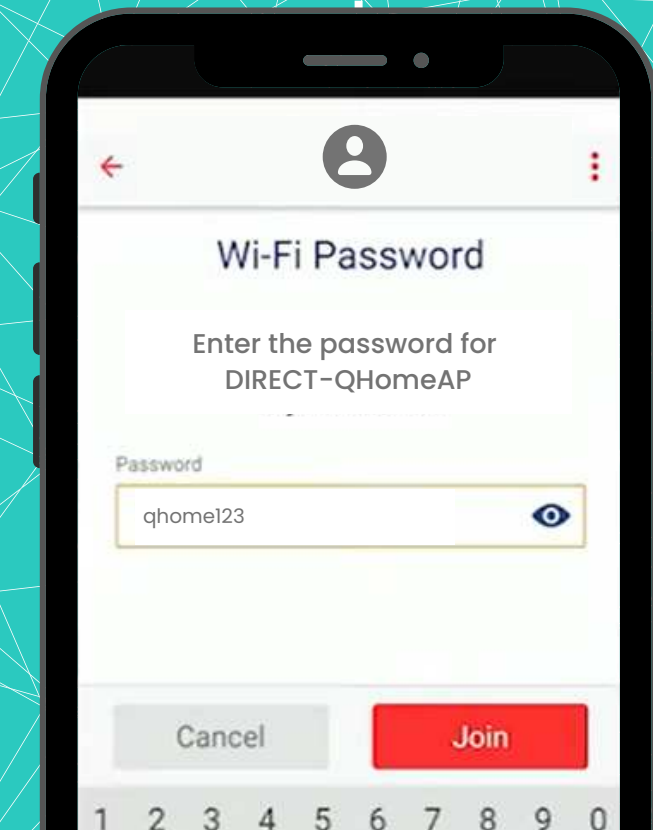

If not, take off the dongle cover, press the white button on the dongle for:



Or unplug the dongle then plug it back in.

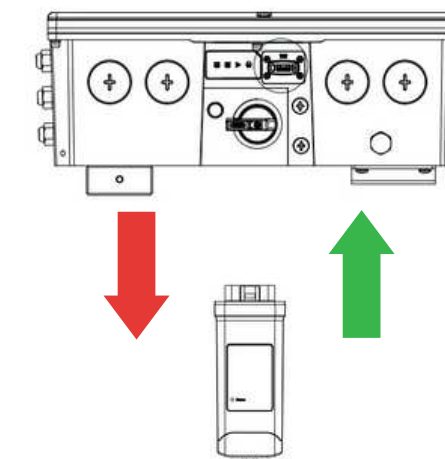



QCELLS Wi-Fi Commission Instruction

Page 2 of 3



STEP 4

Open your mobile web browser then put in the address
<https://192.168.100.1:7000>
OR
<https://192.168.100.1:7000>

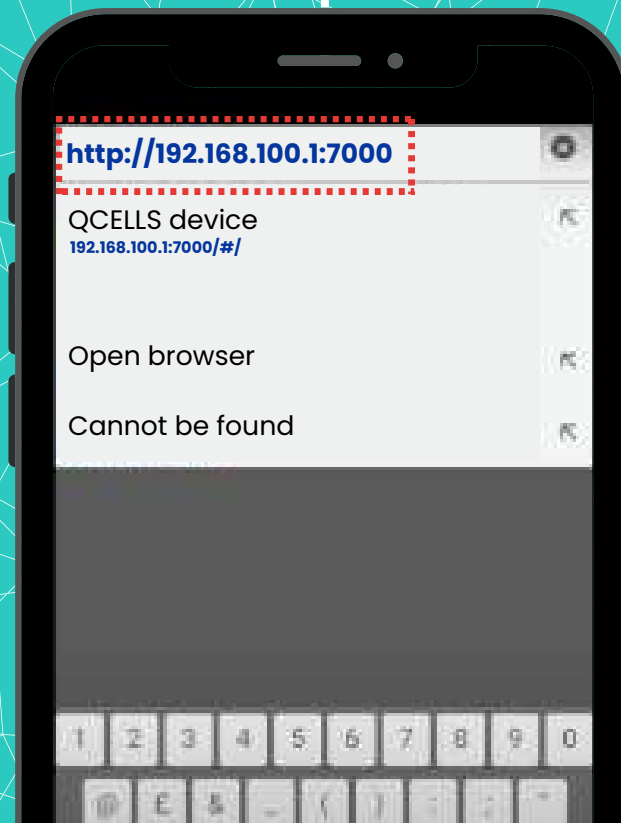

STEP 5

Login the setting page, the password is the last four (4) digits of the inverter serial number or a special password set by your installer



STEP 6

Click on the button on the right corner and go into **"Network"**

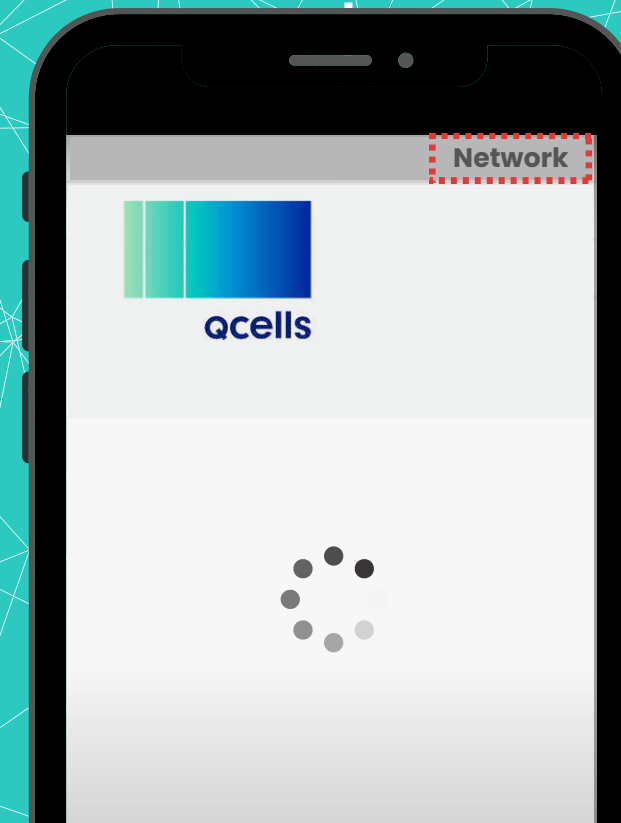



QCELLS Wi-Fi Commission Instruction

Page 3 of 3



STEP 7

In the WIFI section,
choose your home WIFI and
put in the WIFI password

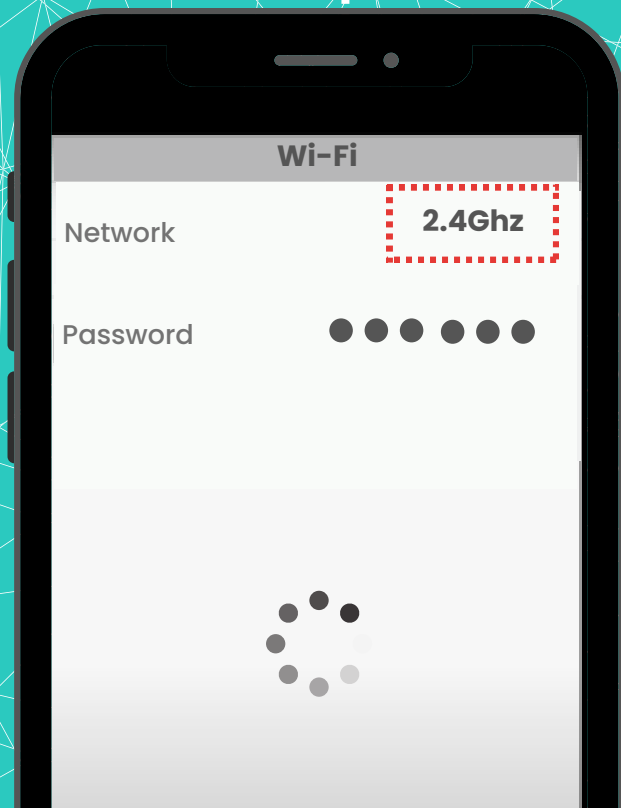

Please make sure to
use 2.4Ghz network
not 5Ghz



STEP 8

Click the QOMMAND
logo on the top left
corner to go back to
main page



Then you can check
the WIFI status, of
the network is
showing a BLUE dot,
it means WIFI is
connected



Network

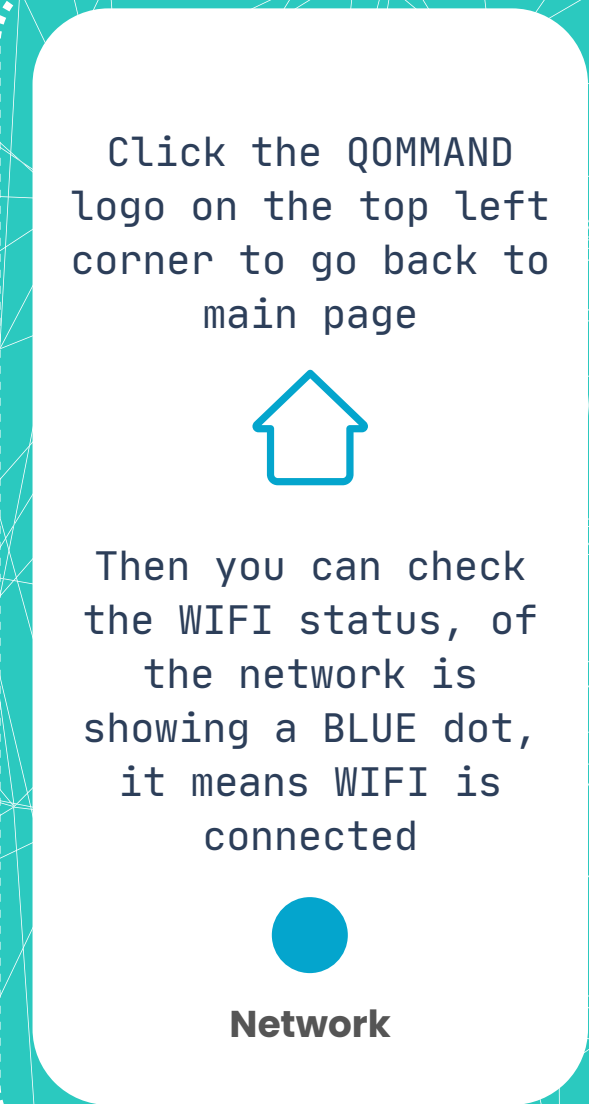

STEP 9

Now, back to
QOMMAND HOME App
and check your
system

